

SLH30-100A

# 30-51 MM ALUMINUM CLAMP – 28 MM WIDTH

Clamp for trusses with sections between 38 and 51 mm.

Maximum load 100kg

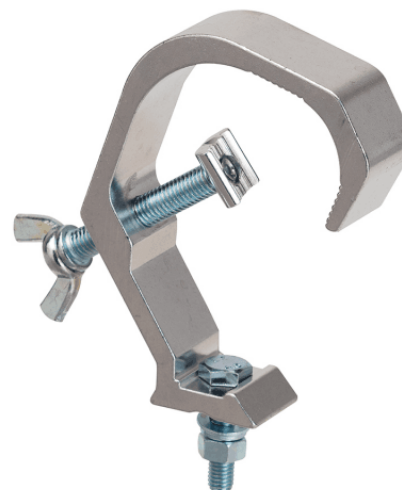

## PRODUCT DETAILS

### KEY FEATURES

Width: 28 mm

Safe working load: 100 kg

Fit tube Diameter: Ø30-51 mm

Material: Aluminum Alloy 6061-T6

Accessories: M10x60 Wing bolt

Surface Treatment: Polishing

Color: Aluminum

Note: Claw at the end of bolt